

The Corps building is an essential part of the Salvation Army's educational, religious, and recreational programs throughout the U.S.

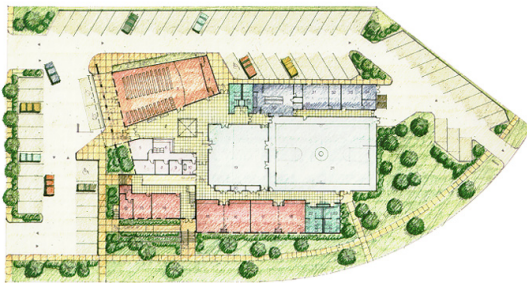

SALVATION ARMY

St. Charles Corps Building
St. Charles, Illinois

Transformation

The proposal for St. Charles transformed an existing sanctuary and several classrooms into a cohesive, multi-use center, through the careful addition of a new gymnasium and the central foyer. These and all parts of the building are easily reached from the prominent sky lit entry. Overall, an image of permanence is conveyed by the careful use of interior and exterior finish materials, selected for their ease of maintenance and durability.

Growth

The Master Plan allows for the incremental expansion of the gymnasium and classrooms. But future growth will not affect the careful siting of the parking, which is adjacent to the multi-use gymnasium and shielded from street views.