



AT&T WIRELESS SERVICES

Bloomington, Minnesota

High-tech Cafe And Lounge

Faced with great competition in the employment market, AT&T Wireless wanted to create an environment that would help to attract and maintain a college-aged staff. In addition, there was a need to create a space where employees could escape the stresses of call center life. With this in mind, TKA designed a new, high-tech cafe and lounge. Bright colors and high-tech finishes enliven the space and cater to its young staff.

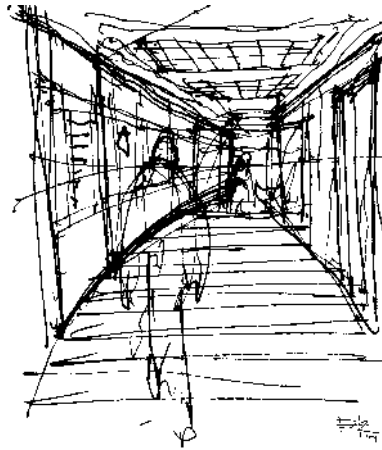

Environmental Purity

Increasingly in today's workplace, air quality has become a major issue. When beginning the design process, TKA discovered a mold problem at the existing facility. TKA coordinated the abatement of the mold, as well as developed a palette of materials that would not outgas harmful fumes. This was especially important because the construction was taking place during call center operation.

Schedule And Cost Driver

One of a handful of national call centers, the timing and coordination became a major driver to keeping this national call center on line throughout the construction process. With a quickly growing and changing organization, TKA was able to immediately respond to changing programmatic needs.

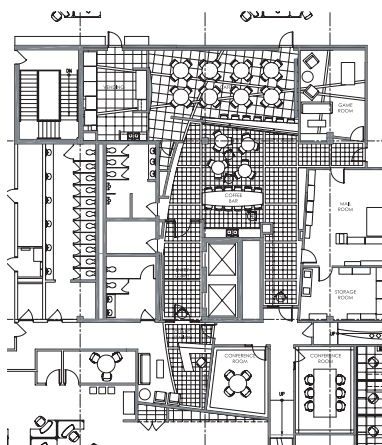

With the advent of the recession, many large companies have become increasingly cost conscious. The desire to minimize capital expenditures, TKA developed a system of using an inexpensive design solution to enliven to large general office area. This allowed a greater amount of money to be allocated for the smaller shared, elevator lobby, staff lounge and cafe.